

SMTM
MOTAWAT



MOTAWAT



SHUBH

GROUP OF COMPANIES

Enriching Relationships

INDIA

www.motawatshubhgroup.com | info@motawatshubhgroup.com

REAL ESTATE | NATURAL STONE | METALS | IFMCG | FIBER | PET PREFORM



Corporate Outline

Shubh Group of Companies, an India based Business Corporate, established in 1981 is soaring amongst its peers by offering the vibrant combination of technology & services that gives its patrons greater economic returns and scalable environment for growth.

“Enriching Relationships”

Is what we aim at.

“World has no limit”

Is our mantra.

Shubh Group empowers decisions with the foremost thinking on high quality business challenges in different domains of the business world. We give instant access to services on different sectors which include **Real Estate & Infrastructure Development, Natural Stone, PET Preform, Polyester Fiber,** and **FMCG.**



Who We Are?



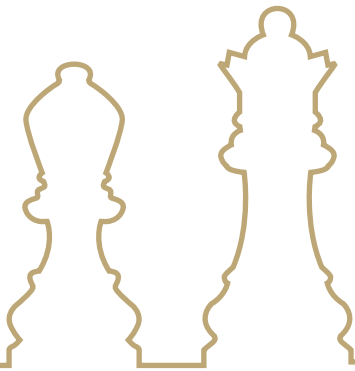

Starting a Business is easier but converting it into client relations is difficult. Establishments usually feature numerous challenges as they try to strengthen their foundation.

Shubh Group with its head office in Udaipur, Rajasthan, India has established itself as one of the finest business corporations, with a motive to set itself up amongst leading universal business service providers.

The organization has achieved the feat with its global presence in different parts of the globe which include **India, UAE, Singapore, Australia, Indonesia, USA & UK.**

The factor that has improved the productivity of **Shubh Group** is its capability of extensive and in-depth knowledge in all fields with respect to the services provided and customer friendly approach.



VISION



To become **preferred Business Group** in our sectors by providing **high standard solutions** for the betterment of the society.

MISSION

"Enriching Relationships"



As a team we lay emphasis on :

- **Customer Satisfaction**

We express our efforts towards our clients so as to understand their requirements and prospects in a timely & cost effective manner.

- **Merchant Contentment**

Shubh Group makes sure that the vendors & merchants get the best out of us.

- **Employee's Joy**

Shubh Group has a different work environment & culture which generates a sense of security within its employees and develop them to their full potential.

- **Business Excellence**

We expect and demand the best we have to offer by always keeping **Shubh's values at top of the mind.**



Core Values



Honesty is the Biggest Wealth

We work with our clientele to identify their aspirations and always make sure we deliver what client calls for.

We discover potential and clinch thoughts with a “**we can**” approach. As said, “**nothing is impossible**”, we try to provide solutions for every problem.

We chase contentment and our client's amusement is directly related to our delight. Client satisfaction is the best reward we cherish.

We go steadily ! We work on the traditional concept as “**slow and steady wins the race**”; to make sure we reach the top notch.

We are zealous ! We loom our objective with the passion to get the job done timely, with the defined parameters.

We are devoted ! Learning is an ongoing process, and we follow the same concept, so as to create something innovative.

We survive to help ! We are always here to help you. Join us, and we will help you to get through.



Why Shubh Group?



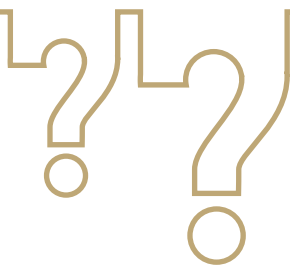

A question might arise in your mind, why choose **Shubh Group** as your partner? The answer is quite simple; **we follow a pre-defined flowchart of work progress, where we give cent-percent results to our customers** In addition, we do stick to certain principles, which strengthen our business, that includes,

Reliability

- Services provided by the team assure our clients pre-eminent results beyond their expectations.

Consistency

- **Shubh Group** has proved itself several times for its consistency and sustained through the confidence of its patrons now and then.

Compliance

- **Shubh Team** follows the instructions from its customers, as a ground rule and all regulations of the authorities.

Practical Approach

We dream of sky, keeping our base attached to the ground. Practical approach is something that **Shubh Group** sticks to, right from the foundation.

Quality

Quality is the main pedestal which has helped **Shubh Group** to mark its presence across the globe. We make certain to provide 100% quality & top mark services at the client end.





Promoters



B. L. MOTAWAT
(CHAIRMAN)

Chairman - Mr. B. L. Motawat

Mr. Motawat, an incredible visionary and exceptional leader who leads by example, established **Shubh Group** in the year 1981 at Udaipur, Rajasthan pioneering in Real Estate & Development. Integrated with rare amalgamation of distinctiveness as values, veracity, dynamism, inimitability and risk management, he brought **Shubh Group** to its pinnacle and extended it to the rest of the world.

Message from the Chairman

At Shubh we have a strong set of values that springs in through everything we do.



ROHIT MOTAWAT
(MANAGING DIRECTOR)

Managing Director - Mr. Rohit Motawat

Mr. Rohit Motawat (son of Mr. BL Motawat) joined **Shubh Group** of Companies in 2005 as Managing Director and expanded the group in very diminutive width of time. A young & dynamic management graduate, known for his passionate & self-motivated approach has helped **Shubh Group** to reach new heights. His business ethics, creativity, commitments, time management & relationship building has helped him to lead the vast realm of business in such a short span of time.

Message from the MD

Being a young entrepreneur my passion comes with “we can” attitude & limitless energy for creativity. My deliverance and commitment to broader the horizon of **Shubh Group** leads my vision.



SHIKHA MOTAWAT
(DIRECTOR)

Director - Mrs. Shikha Motawat

Ms. Shikha Motawat, a Management Graduate has joined the group as Director in 2015.

She brings dynamism and customer focused approach to the group. Her down to earth attitude, passion for quality in everything she does and practical approach provides special filip to the group.

Message from the Director

In line with the company's Vision, Mission and Values, would like to build long term relationships with our associates by providing uncompromised quality of service and give them full satisfaction and delight in a most transparent manner.



The Group & Its Family



Shubh Group is one of the prominent & foremost business corporates which laid its foundation with

Real Estate & Infrastructure Development

Shubh Group has provided its services in other spheres of influence which include -

Natural Stone

Metal

PET Preform

Polyester Fiber

FMCG

The main focus of the organization has always been emphasizing on customer satisfaction with the overall development and value addition to all stake holders.

Real Estate & Infrastructure

- Shubh Builders & Developers
- Shubh Grah Realty (P) Ltd
- AVR Realty (P) Ltd
- Shubh Builders

Natural Stone

- Shubh Mangal Marble & Granites (P) Ltd
- Shubh Overseas (P) Ltd

Metal

- Shubh Grah Metals (P) Ltd.
- Shubh Iron Traders
- Shubh Aluminium (P) Ltd
- Shubh Grah Enterprises
- Shubh Shivam Traders

FMCG

- Shubh Mangal Enterprises



Our Portfolio

Pre Polyester Fiber

- Shubh YS Fibers

PET Preform

- Shubh Preform Industry



Sf
NOTAWAY
SRINAGAR

LUDHIANA

Sf
NOTAWAY

SHIMLA

Sf
NOTAWAY

Sf
NOTAWAY

BHIWADI

Sf
NOTAWAY

DELHI

Sf
NOTAWAY
JAIPUR

Sf
NOTAWAY
UDAIPUR

HIMMAT NAGAR

Sf
NOTAWAY

Sf
NOTAWAY

AHMEDABAD

Sf
NOTAWAY

INDORE

DAMAN

Sf
NOTAWAY

Sf
NOTAWAY

SILVASSA

MUMBAI

Sf
NOTAWAY

Sf
NOTAWAY

PUNE

Sf
NOTAWAY

THANE

Sf
NOTAWAY

HYDERABAD



Worldwide Approach

Our widespread global presence allows us to offer our customers with a unique combination of broad global resources & technical expertise with profound local awareness. This includes our marketplace around the world where we continue to expand our worldwide existence & reinforce our international partnerships. With such a broad and ever-expanding physical presence, we are always keen to add talents from different places, to our teams. Starting from scratch we have crossed the boundaries internationally & currently we have our global presence in the following countries:

India - Corporate Headquarter

Singapore

Indonesia

Australia

USA

UAE

UK

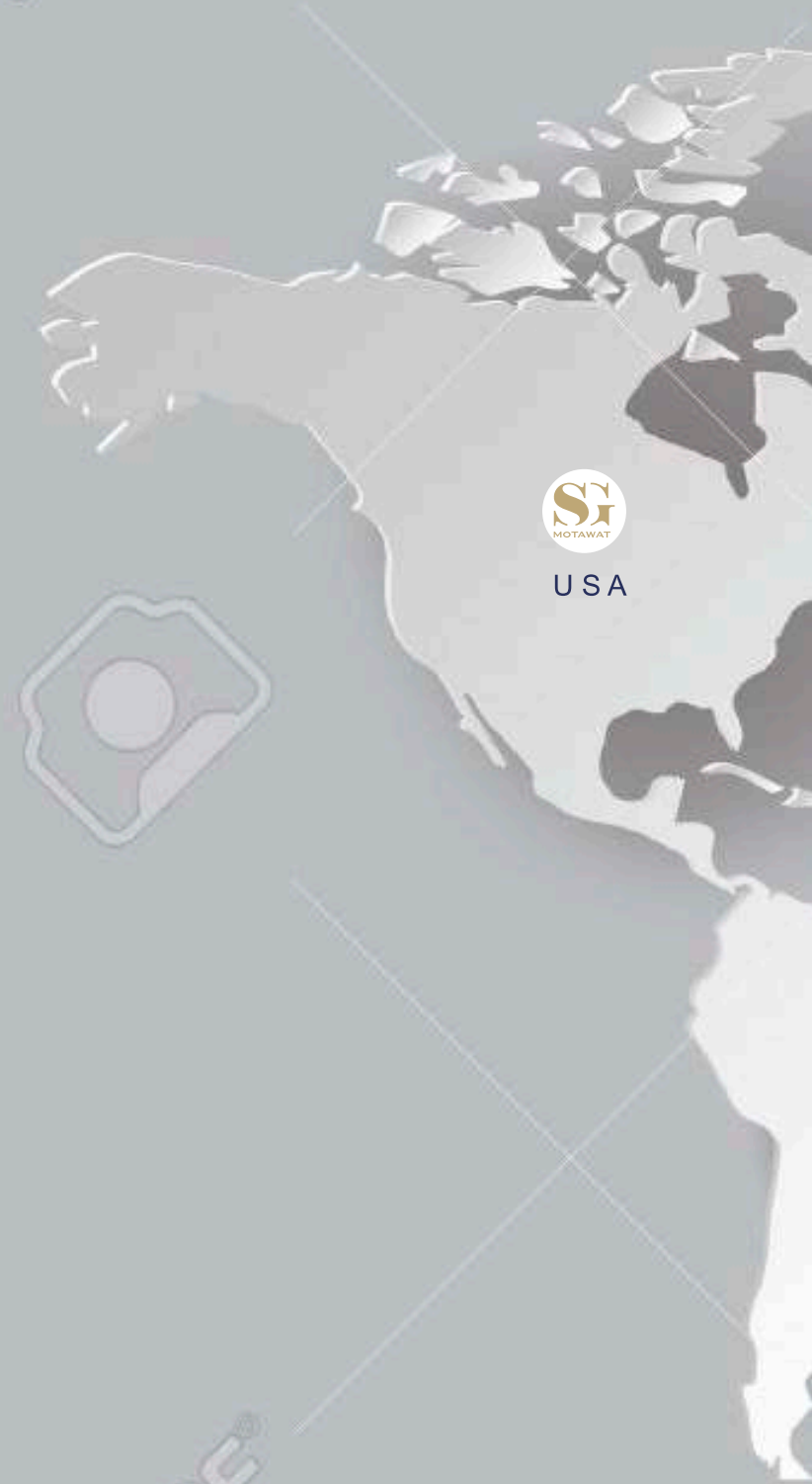



UK



UAE



INDIA



SINGAPORE



INDONESIA



AUSTRALIA



**Real Estate &
Infrastructure**



Shubh Group initiated its long journey with Real Estate Company more than two decades back. This business has always been a challenging task to be accomplished by any real estate developer. But with a sturdy & sincere effort, **Shubh Group** leads the market with a vision to transform India & become one of the most successful & respectful Real Estate entity.

The number of projects concluded by our team has always worked as an asset for our future endeavors. With its yardstick standards of construction quality & customer service, **Shubh Group** stands ahead in the pursuit of Real Estate business through its flourishing contributory presence in Udaipur, Jaipur, Mumbai and Pune & many more to go. As they say, sky has no limits; **Shubh Group** has started extending its reach across Pan-India. In the same league, we have acquired land in some major cities. Adding to it, we have started exploring international market in order to grab the opportunity.

Besides we are also involved in various infrastructure development projects of central and state governments.



Real Estate &
Infrastructure

Portfolio

PRESTINE

YEAR : 2016
UNIT : 125
SQ. FT. : 1,20,000
CITY : UDAIPUR
STATUS : UPCOMING

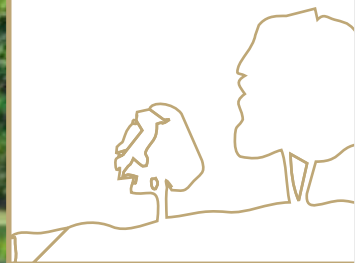
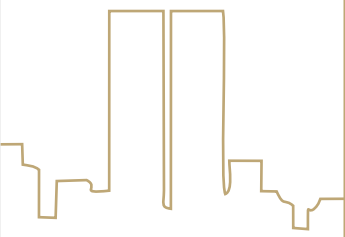



SHUBH ASPIRE

YEAR	:	2016
UNIT	:	52
SQ. FT.	:	50,000
CITY	:	UDAIPUR
STATUS	:	UPCOMING



Real Estate &
Infrastructure

Portfolio

SHUBH CORPORATE PARK

YEAR : 2016
UNIT : 40
SQ. FT. : 75,000
CITY : MUMBAI
STATUS : UPCOMING



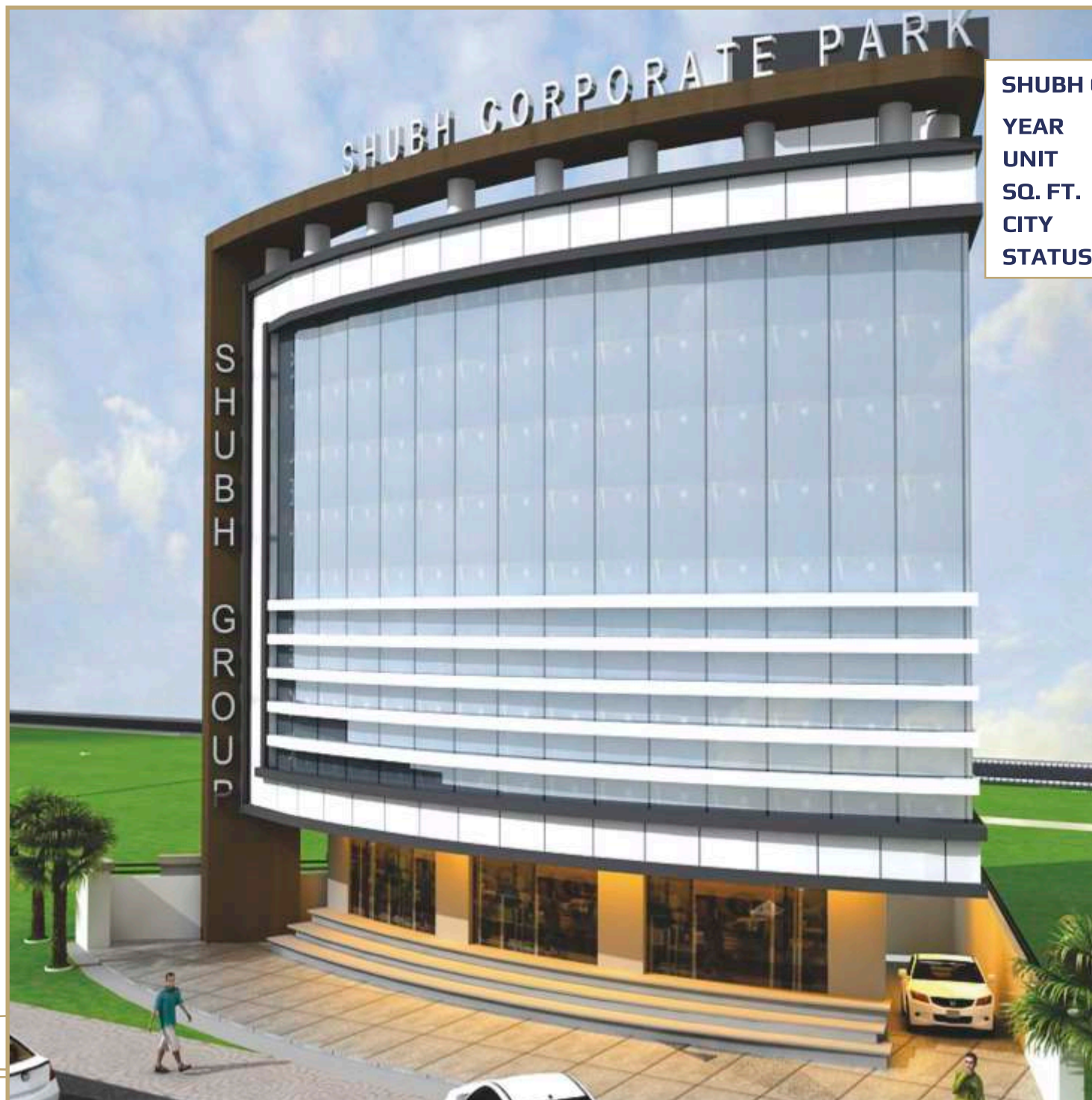

SHUBH CORPORATE PARK

YEAR : 2015
UNIT : 15
SQ. FT. : 14,000
CITY : UDAIPUR
STATUS : ONGOING



Real Estate &
Infrastructure

Portfolio

SAMPADA

YEAR : 2015
UNIT : 60
SQ. FT. : 1,00,000
CITY : UDAIPUR
STATUS : ONGOING





SHUBH NIWAS

YEAR : 2015
UNIT : 150
SQ. FT. : 2,00,000
CITY : UDAIPUR
STATUS : ONGOING



Real Estate &
Infrastructure

Portfolio

AVANA

YEAR : 2015
UNIT : 82
SQ. FT. : 1,10,000
CITY : JAIPUR
STATUS : ONGOING

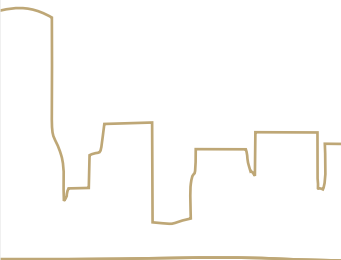
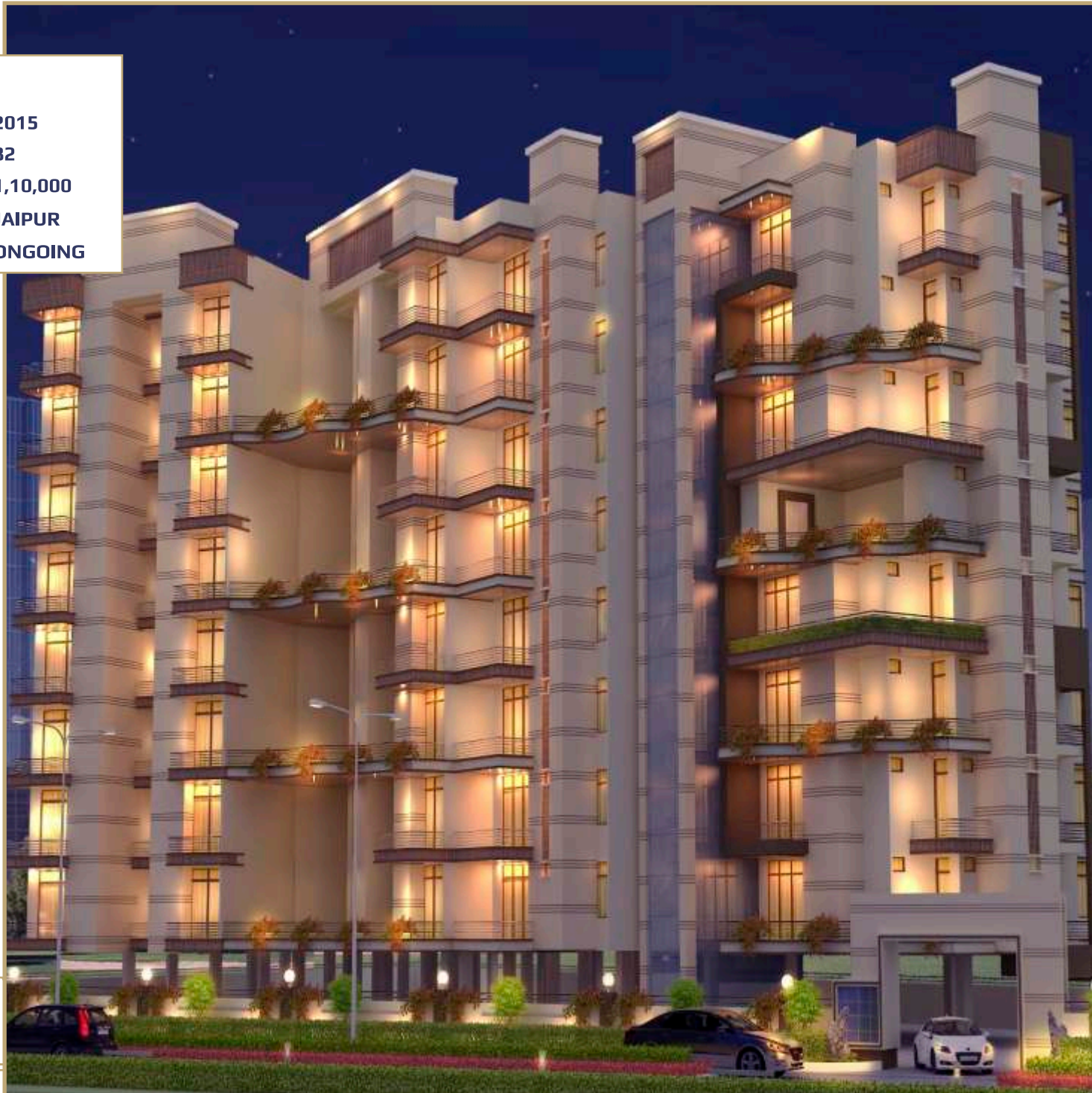

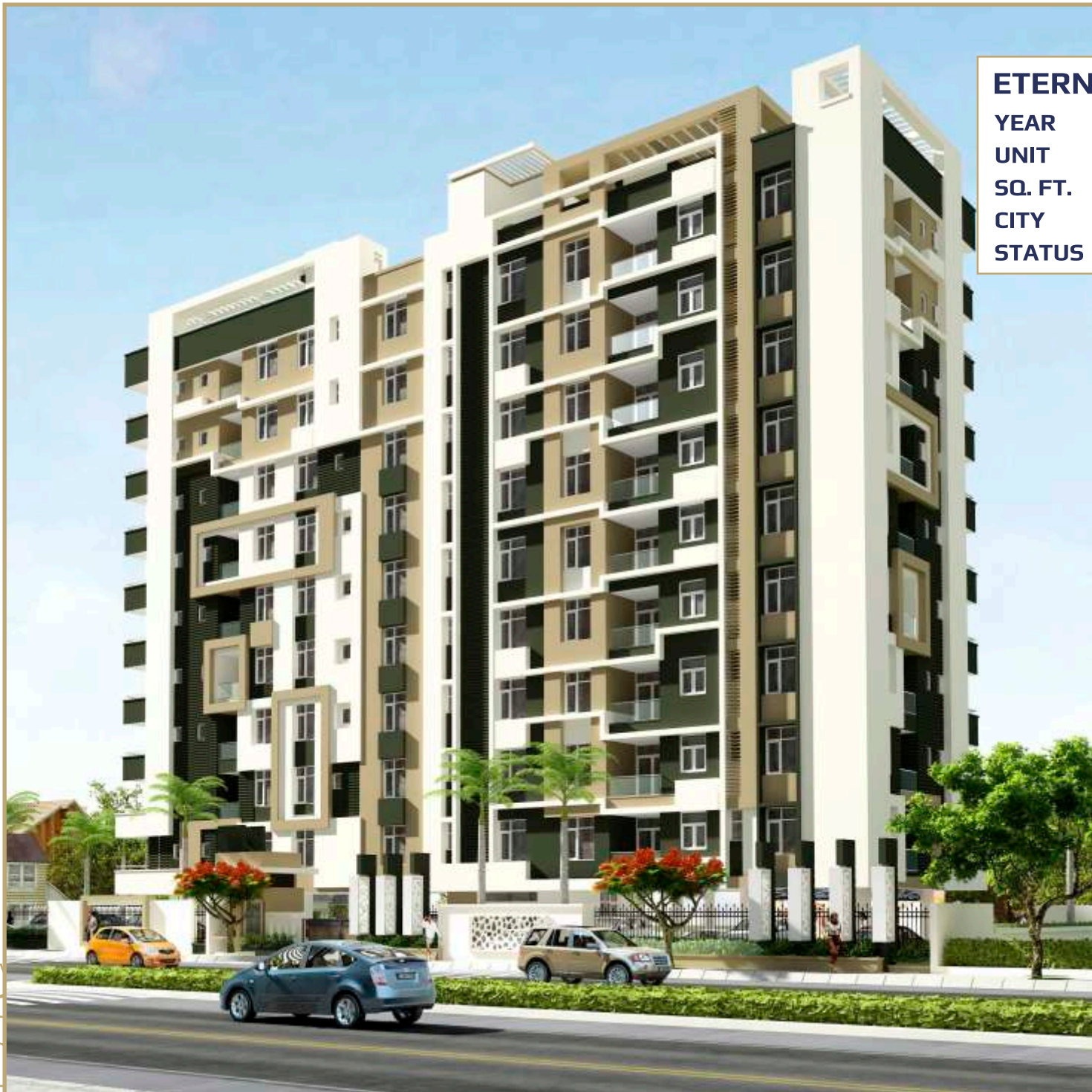

ETERNIA

YEAR : 2015
UNIT : 60
SQ. FT. : 60,000
CITY : JAIPUR
STATUS : ONGOING

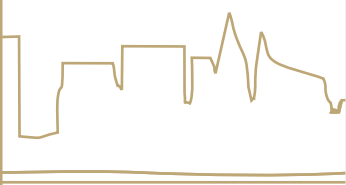

RICHMOND

YEAR : 2015
UNIT : 250
SQ. FT. : 2,50,000
CITY : PUNE
STATUS : ONGOING





PARASNATH NAGRI

YEAR : 2013
UNIT : 2200
SQ. FT. : 10,00,000
CITY : MUMBAI
STATUS : ONGOING



SAGAR DARSHAN

YEAR	UNIT	SQ. FT.	CITY	STATUS
1998	100	1,20,000	UDAIPUR	COMPLETED



SHUBH APARTMENT

YEAR	UNIT	SQ. FT.	CITY	STATUS
2004	16	45,000	UDAIPUR	COMPLETED



RIDDHI SIDDHI APARTMENT

YEAR	UNIT	SQ. FT.	CITY	STATUS
1998	40	50,000	UDAIPUR	COMPLETED



SHUBH LABH

YEAR	UNIT	SQ. FT.	CITY	STATUS
2007	70	1,10,000	UDAIPUR	COMPLETED



DIVYA JYOTI

YEAR	UNIT	SQ. FT.	CITY	STATUS
2000	120	1,30,000	UDAIPUR	COMPLETED



SHUBH TOWER (1)

YEAR	UNIT	SQ. FT.	CITY	STATUS
2013	130	1,50,000	UDAIPUR	COMPLETED



SHUBH LAXMI APARTMENT

YEAR	UNIT	SQ. FT.	CITY	STATUS
2012	110	1,30,000	UDAIPUR	COMPLETED



SHUBH MANGAL APARTMENT

YEAR	UNIT	SQ. FT.	CITY	STATUS
2014	16	16,000	UDAIPUR	COMPLETED



SHUBH AASHIYANA

YEAR	UNIT	SQ. FT.	CITY	STATUS
2013	36	85,000	UDAIPUR	COMPLETED



DIVYAM HEIGHTS

YEAR	UNIT	SQ. FT.	CITY	STATUS
2007	160	1,00,000	MUMBAI	COMPLETED



JAI VIJAY NAGAR

YEAR	UNIT	SQ. FT.	CITY	STATUS
2010	750	4,00,000	MUMBAI	COMPLETED



PARASNATH NAGRI

YEAR	UNIT	SQ. FT.	CITY	STATUS
2012	2200	10,00,000	MUMBAI	ONGOING



Natural Stone



Shubh Group established its natural stone business in the year 2005, wherein it delivers natural forms of **Marble, Granite & Sandstone products across the Globe**. Whatever is the requirement, raw Marble or the finished one, the company delivers the quality product within the given time frame across any part of the world at most affordable prices.

Our Marble production unit is based in Sukher Industrial Area, Udaipur, which is operating since 2005. As of now we have **four Gang saw units** where we process domestic & imported raw material and the finished product is released in the market for sale.

We are also planning to expand our Natural Stone Business abroad.





NATURAL STONE

Infrastructure







Metal Industry



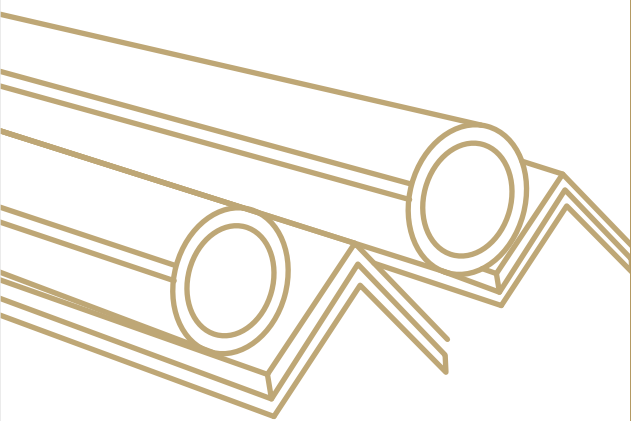

Shubh Group entered Metal Segment not too long back & has succeeded here as well. We currently manufacture Aluminium extrusion & a wide range of alloys (including hard & soft). We do import Aluminium scrap from Dubai, Singapore & Australia.

Our existing plant is located at Bhiwadi, Near New Delhi. In order to expand our metal segment we have already purchased land near Himmatnagar, Gujarat. Soon the production unit would be commenced.





PET Preform Industry





PET Preform Industry is one of the most prominent emerging industries of current time, throughout the world. **Shubh Group** apparently is one of the major water bottle preform manufacturers based in Udaipur. Our manufacturing unit commenced production in December, 2015 at Madri Industrial Area of Udaipur.

We possess advanced manufacturing infrastructure, sophisticated laboratories & state of the art machineries which includes the moulding machine from **Husky Electronics International, Inc.**

Our course of preform production has been appreciably classified in two stages, so as to get the desired production. The former stage includes the fetching of quality raw stuff from the market. In the second step, the raw material is processed in our moulding machines so as to get the desired water bottle Preforms, which is further shipped to the market, so that the same can be converted into finished water bottles.

Currently we are manufacturing Bottle Preforms in the range of 1 liter to 20 liters. Soon other variants would also be made available.



PET Polyester Fiber



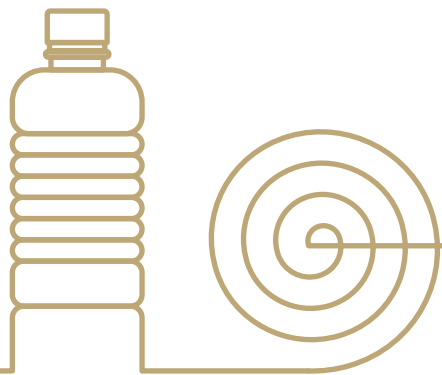

Shubh Group again has set a benchmark with its efforts of making environment pollution free. In the same context we have launched our polyester fiber branch quite long back. We are one of the major PET Polyester manufacturers in India. With our noteworthy laboratories of R&D, we have endowed the textile market with some unmatched products.

Our current procedure flowchart has been divided into six segments; wherein we fetch the plastic wastes from the market, refine the same in order to get the usable material. The material is then converted in the form of synthetic threads, which is then used in the manufacturing of various fabrics including polyester sports goods & wearable cloths.

Our manufacturing & processing units are located at Daman & Silvassa. Finished goods are supplied PAN-India.





FMCG Industry





Shubh Group has entered the Food market, wherein the organization has again laid emphasis on its core values to serve its clientele. The subsidiary division of **Shubh Group** commenced in 2015 is dealing in the Fast Moving Consumer Goods (FMCG) market.

We Export superior quality Grains, Pulses, Flours & Fruits (especially Banana, Coconut, Apple & Pomegranate) to the international market which predominantly includes the Middle East comprising of United Arab Emirates (UAE) & Kingdom of Saudi Arabia (KSA).

On the other hand, we have also tied-up with **YES** for Marketing of **YES Mineral Water** and **Revive Jeera Masala** in Maharashtra, India.





AWARDS & RECOGNITION



Shubh Group of Companies has been into Real Estate & Infrastructure Industry for past two decades. The business kickstarted at Udaipur, Rajasthan and is now serving across India and also has a wide global presence.

As a result of the incomparable efforts by Mr. Motawat, **Shubh Group** has been honored with “**Diversified Real Estate Company of the Year**”. Mr. Rohit Motawat, Managing Director of the company received the award.





Follow us on:



UDAIPUR - Head Office

1 Link Road, Town Hall
Udaipur, Rajasthan - 313001, India

L : +91 294 2 420 200
M : +91 93 144 78 101
E : udaipur@motawatshubhgroup.com

MUMBAI - Corporate Office

Business Point - A 501, 5th Floor
Near Air Cargo Complex, Sahar Int. Airport
Andheri - E, Mumbai, Maharashtra - 400099, India

L : +91 22 26 82 87 31 / 32
M : +91 70 456 69 501 / 02
E : mumbai@motawatshubhgroup.com

BRANCH OFFICES:

UDAIPUR

1, Shubh Aashiyana Appartment
Ayad Shobhagpura 100 Ft. Road
Udaipur, Rajasthan - 313001, India

L : +91 294 2 981 001 / 002
M : +91 93 144 56 850
E : udaipur@motawatshubhgroup.com

JAIPUR

Studio One, 202-203, 2nd Floor
Sahkar Marg, Tonk Road
Jaipur, Rajasthan - 302015, India

L : +91 141 2 74 20 01
M : +91 70 739 99 141
E : jaipur@motawatshubhgroup.com

PUNE

Sai Ambiance, A 402, Plot 2B
Near Planet Millennium, Pimple Saudagar
Pune, Maharashtra - 411027, India

L : +91 20 27 40 55 00 / 01
M : +91 83 902 68 777
E : pune@motawatshubhgroup.com

AHMEDABAD

4D Square, Off No. 29, 3rd Floor
Gandhinagar Highway, Motera
Ahmedabad, Gujarat - 380005, India

L : +91 79 27 70 01 89
M : +91 97 129 63 031 / +91 93 144 56 850
E : ahmd@motawatshubhgroup.com



SHUBH
GROUP OF COMPANIES
Enriching Relationships